

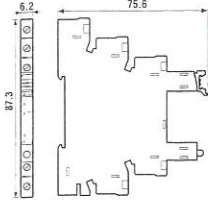

93.01

Approvals
(according to type):



Relay type	34.51, 34.81	
Screw terminal socket: 35 mm (EN 50022) mounting		
Supply voltage	Relay type	Socket type
12 VAC/DC	34.51.7.012.xx10	93.01.0.024
24 VAC/DC	34.51.7.024.xx10	93.01.0.024
48 VAC/DC	34.51.7.048.xx10	93.01.0.060
60 VAC/DC	34.51.7.060.xx10	93.01.0.060
110...125 VAC/DC	34.51.7.060.xx10	93.01.0.125
220...240 VAC/DC	34.51.7.060.xx10	93.01.0.240
110...125 VAC/DC*	34.51.7.060.xx10 or 34.81.7.060.xxxx	93.01.3.125*
220...240 VAC*	34.51.7.060.xx10 or 34.81.7.060.xxxx	93.01.3.240*
6 VDC	34.51.7.005.xx10	93.01.7.024
12 VDC	34.51.7.012.xx10	93.01.7.024
24 VDC	34.51.7.024.xx10 or 34.81.7.024.xxxx	93.01.7.024
48 VDC	34.51.7.048.xx10	93.01.7.060
60 VDC	34.51.7.060.xx10 or 34.81.7.060.xxxx	93.01.7.060



93.51

Approvals
(according to type):

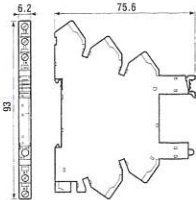

Relay type	34.51, 34.81	
Screwless terminal socket: 35 mm (EN 50022) mounting		
Supply voltage	Relay type	Socket type
12 VAC/DC	34.51.7.012.xx10	93.51.0.024
24 VAC/DC	34.51.7.024.xx10	93.51.0.024
110...125 VAC/DC	34.51.7.060.xx10	93.51.0.125
220...240 VAC/DC	34.51.7.060.xx10	93.51.0.240
110...125 VAC/DC*	34.51.7.060.xx10 or 34.81.7.060.xxxx	93.51.3.125*
220...240 VAC*	34.51.7.060.xx10 or 34.81.7.060.xxxx	93.51.3.240*
12 VDC	34.51.7.012.xx10	93.51.7.024
24 VDC	34.51.7.024.xx10 or 34.81.7.024.xxxx	93.51.7.024
60 VDC	34.51.7.060.xx10 or 34.81.7.060.xxxx	93.51.7.060

* Leakage current suppression



93.11

Approvals
(according to type):



- RATED VALUES: 6A - 250 V
- INSULATION: ≥ 6 kV (1.2/50 μ s) between coil and contacts
- PROTECTION CATEGORY: IP 20
- AMBIENT TEMPERATURE: (-40...+70) °C

Relay type	34.51/34.81
Colour	BLUE
P.C.B. sockets with retaining and release clip	93.11

Retaining and release clip use:

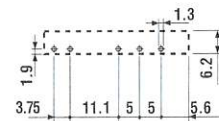
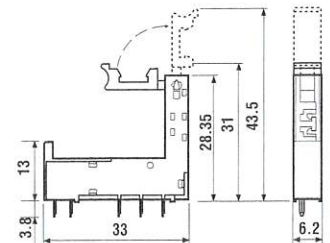
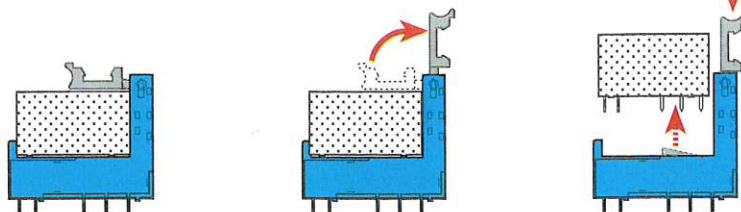

Copper side view